



Equipped with AEM® Dryflow™ Filter
No Oil Required!

INSTALLATION INSTRUCTIONS

PART NUMBER: 21-678

2010 MITSUBISHI Lancer Evolution L4-2.0L
2008 MITSUBISHI Lancer Evolution L4-2.0L

See * NOTE
C.A.R.B. E.O. # D-670

* NOTE: Legal in California only for racing vehicles which may never be used upon a highway

PARTS LIST

Description	Qty.	Part Number
A	1	21-203DK
B	1	2-6781
C	1	20-6781
D	1	5-6781
E	1	9-6781
F	1	8-4014
G	1	5-6018
H	1	1228598
I	2	2-926
J	2	8-148
K	2	5-2275
L	2	5-3004
M	1	69801
N	2	1-2105
O	5	1-112
P	5	1-3001
Q	2	559999
R	2	444.460.04
S	1	9444
T	1	9448
U	1	9452
V	2	4093-3

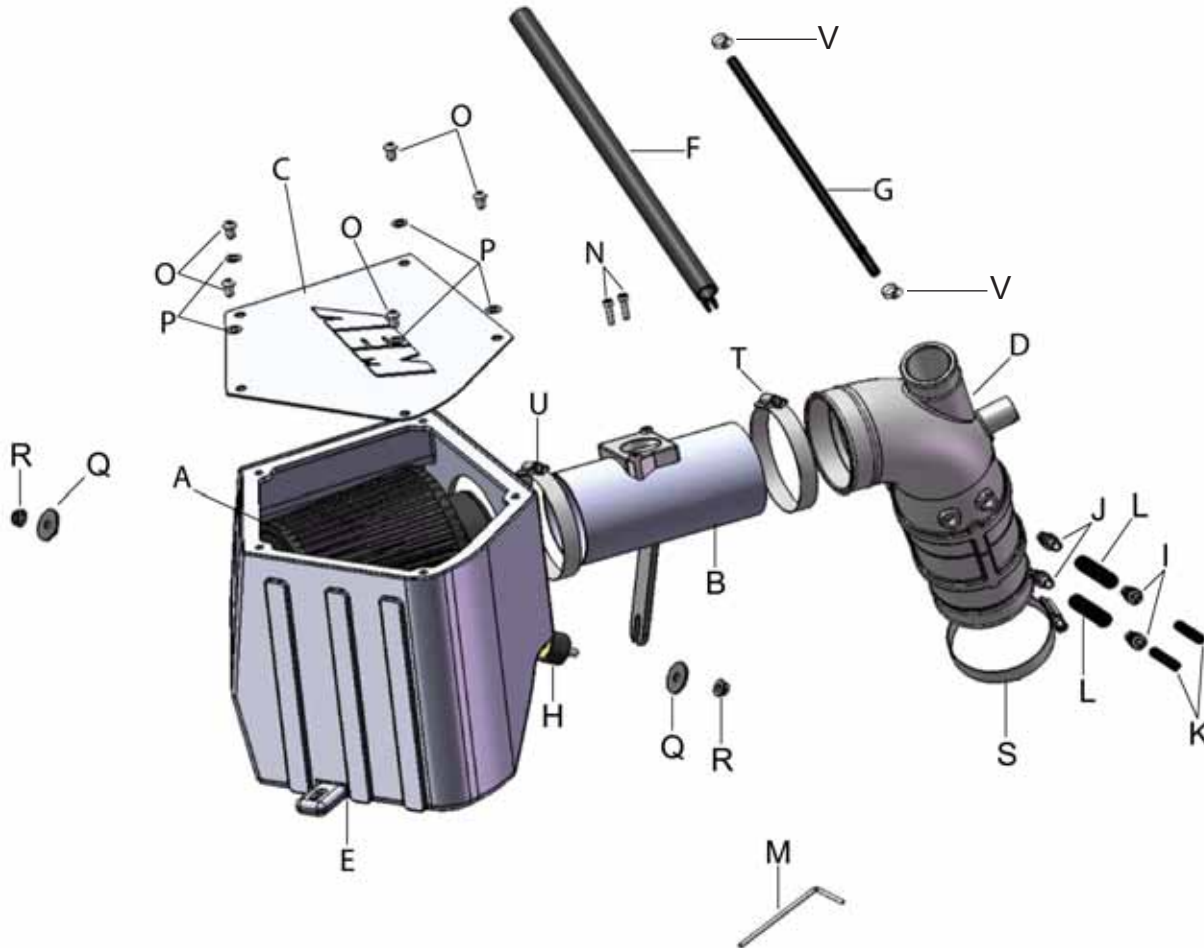

Read and understand these instructions **BEFORE** attempting to install this product. Failure to follow installation instructions and not using the provided hardware may damage the intake tube, throttle body and engine.

1. Preparing Vehicle

- a. Make sure vehicle is parked on level surface.
- b. Set parking brake.
- c. If engine has run in the past two hours, let it cool down.
- d. Disconnect negative battery terminal.
- e. Do not discard stock components after removal of the factory system.

2. Removal of stock system



a. Stock air box system.



b. Disconnect the mass air flow (MAF) sensor harness from the MAF sensor.



c. Using a small screwdriver disconnect the tree mount zip ties from the stock housing, there are two.



d. Remove the bolt securing the OE air box to the vehicle.



e. Loosen the hose clamp securing the rubber inlet tube to the stock air box assembly.



f. Remove the air bypass valve hose from the OE inlet tube by pulling it toward the passenger side of the vehicle.



g. Remove the two plastic rivets shown in the pictures.



h. Disconnect the OE inlet tube from the air box and remove the air box from the engine bay by pulling straight up.



i. Disconnect the air bypass valve hose from the air bypass valve.



j. Use pliers to compress the hose clamp securing the vacuum line to the air bypass valve and move it away from the air bypass valve.



k. Disconnect the vacuum line from the air bypass valve.



l. Disconnect the PCV hose from the OEM inlet tube.



m. Disconnect the two vacuum lines connected to the wastegate solenoid, it connects to the inlet tube.



n. Loosen the hose clamp securing the inlet tube to the turbo inlet. Remove the inlet tube.



o. Remove the vacuum line from the vehicle that was connected to the air bypass valve.



p. Remove the air bypass valve from the inlet by loosening the hose clamp on the inlet tube.



q. Remove the hose clamp from the inlet tube.



r. Remove the MAF sensor from the air box housing using the supplied tamper proof torx tool.



s. Unclip the two clips holding the air box housing together. And disassemble the air box.



t. Remove the inlet duct from the air box by squeezing the top two tabs and pushing out.



u. Remove the two grommets on the bottom of the air box housing. They will be used later.

3. Installation of AEM® intake system.

a. When installing the intake system, do not completely tighten the hose clamps or mounting hardware until instructed to do so.



b. Install the supplied rubber mount. The rubber mount should be located on the outside of the air box. The washer and supplied nut should secure it from the



c. The inlet duct should snap into place in the oval opening, and install the edge trim around the circular hole on the back of the air box.



d. Install the two OE rubber grommets removed in step 2u. in the two holes on the bottom of the AEM® air box.



e. Place the AEM® air box in the vehicle aligning the two rubber grommets on the bottom with the two dowels on the air box mount in the car.



f. Align the tab on the air box with the mounting location of the OE air box and use the same bolt removed in step 2(d). Do not over torque the bolts, 15 ft-lbs.



g. Secure the inlet duct using the plastic rivets removed in step 2(g).



h. Insert the two white connectors into the rubber inlet hose.
NOTE: Using glass cleaner to lubricate the parts will help with installation.



i. Install the air bypass valve into the rubber inlet hose and secure with the OE hose clamp.



j. Create an assembly with the 5/16" ID hose and the two aluminum transition couplers, then connect the 5/16" ID hose to the two with connectors installed in step 3h.



k. Install the MAF sensor in the aluminum inlet pipe and secure with the supplied socket bolts.



l. Install the rubber inlet into the vehicle with the air bypass valve toward the top of the engine. Loosely secure the inlet to the turbo inlet with the #44 hose clamp supplied.



m. Install the PCV hose into the rubber inlet hose.



n. Connect the two 5/32" ID hoses to the two nipples on the wastegate actuator exposed in step 2m. Then connect the hoses to the two aluminum connectors on the rubber inlet.



o. Install the aluminum inlet pipe into the rubber inlet pipe, secure it with a #48 hose clamp and align the bracket with the rubber mount installed in step 3b.



p. Reconnect the bypass hose to the bypass valve, and secure it using the OE hose clamp.



q. Install the AEM® Dryflow™ air filter onto the end of the aluminum inlet pipe as shown, and secure it with a #52 hose clamp. Reconnect the MAF sensor harness that was disconnected in step 2b.



r. Align the holes in the AEM® aluminum lid with the threaded holes in the air box. Use the 5 supplied button head screws and plastic washers to secure the lid.



s. Use the supplied 16" of 1/4" ID hose to connect the bypass valve and the vacuum tubing exposed in step 2o. Secure with hose clamps.



Factory air box system installed



AEM® intake system installed

4. Reassemble Vehicle

- a. Position the inlet pipes for the best fitment. Be sure that the pipes or any other components do not contact any part of the vehicle. Tighten the rubber mount, all bolts, and hose clamps.
- b. Check for proper hood clearance. Re-adjust pipes if necessary and re-tighten them.
- c. Inspect the engine bay for any loose tools and check that all fasteners that were moved or removed are properly tightened.
- d. Reconnect negative battery terminals and start engine. Let the vehicle idle for 3 minutes. Perform a final inspection before driving the vehicle.

5. CARB Sticker Placement

- a. The C.A.R.B. exemption sticker, (attached), must be visible under the hood so that an emissions inspector can see it when the vehicle is required to be tested for emissions. California requires testing every two years, other state may vary.

6. Service and Maintenance

- a. It is recommended that you service your AEM® Dryflow™ filter every 20,000 miles for optimum performance. Use AEM Dryflow cleaning kit part # 21-110.
- b. Use aluminum polish to clean your polished AEM® intake tube.
- c. Use window cleaner to clean your powder coated AEM® intake tube. **(NOTE: DO NOT USE aluminum polish on powder coated AEM intake tubes).**

For technical inquiries
e-mail us at
sales@aemintakes.com
or
call us at
800.992.3000

AEM Air Intake System Warranty Policy

AEM® warrants that its intake systems will last for the life of your vehicle. AEM will not honor this warranty due to mechanical damage (i.e. improper installation or fitment), damage from misuse, accidents or flying debris. AEM will not warrant its powder coating if the finish has been cleaned with a hydrocarbon-based solvent. The powder coating should only be cleaned with a mild soap and water solution. Proof of purchase of both the vehicle and AEM intake system is required for redemption of a warranty claim.

This warranty is limited to the repair or replacement of the AEM part. In no event shall this warranty exceed the original purchase price of the AEM part nor shall AEM be responsible for special, incidental or consequential damages or cost incurred due to the failure of this product. Warranty claims to AEM must be transportation prepaid and accompanied with dated proof of purchase. This warranty applies only to the original purchaser of product and is nontransferable. Improper use or installation, use for racing, accident, abuse, unauthorized repairs or alterations voids this warranty. AEM disclaims any liability for consequential damages due to breach of any written or implied warranty on all products manufactured by AEM. Warranty returns will only be accepted by AEM when accompanied by a valid Return Merchandise Authorization (RMA) number. Credit for defective products will be issued pending inspection. Product must be received by AEM within 30 days of the date RMA is issued.

If you have a warranty issue, please call (800) 992-3000 and our customer service department will assist you. A proof of purchase is required for all AEM warranty claims.